



**7-18GHZ HIGHPASS FILTER  
WITH SMA FEMALE CONNECTORS  
P/NO.STI15-9969**



**SPECIFICATION**

Pass Band Frequency	7-18GHz
Rejection	45dB min.@DC-5950MHz
Insertion Loss	1.0dB max.@7.2-18GHz
	3.0dB max.@7GHz
Return Loss	11dB min.
Power Handling	15W
Impedance	50 Ohm
Operating Temperature	0~+ 55°C
Connector Type	SMA Female

**MATERIAL LIST**

Part	Material	Plated
Housing	Aluminum	
Connector Body	Stainless Steel	
Center Contact	Barss	Gold

**OUTLINE DRAWING**

Unit:mm

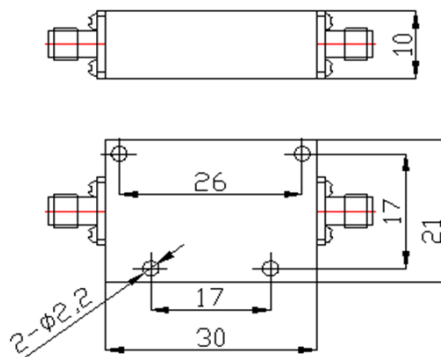

**TESTING DATA ( 100% S-PARAMETER TESTED)**

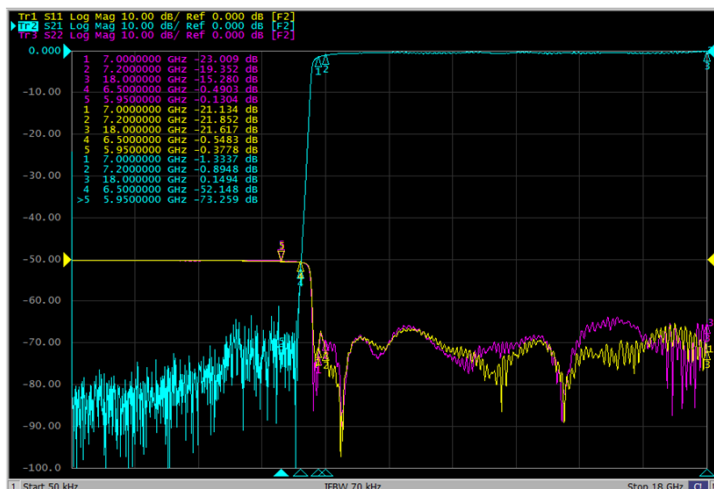

Any more request, please contact sales@solvangtech.com. Thank you ~