



6GHZ SMA FEMALE TO SMA FEMALE ADAPTER

P/NO.STI01-0172



SPECIFICATION

Frequency	DC-6GHz
VSWR:	1.3:1(Max.)
Impedance:	50Ohm
Durability:	500 Cycles
Temperature:	-40~85 °C

MATERIAL LIST

Part	Material	Plated
Body	Brass	Gold
Center Pin	Phosphor Bronze	Gold
Insulator	Teflon	
Press Washer	Brass	Gold

OUTLINE DRAWING

Unit:mm

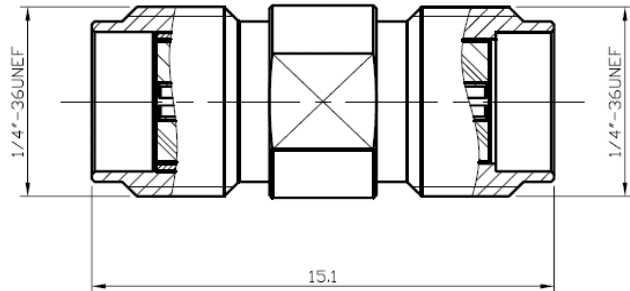

TESTING DATA (100% S-PARAMETER TESTED)

