



10GHZ SMA FEMALE TO SMA FEMALE

ADAPTER

P/NO.STI01-0162



SPECIFICATION

Frequency	DC-10GHz
VSWR:	1.15:1(Max.)
Impedance:	50Ohm
Durability:	500 Cycles
Temperature:	-65~155℃

MATERIAL LIST

Part	Material	Plated
Body	Brass	Gold
Center Pin	Beryllium Copper	Gold
Insulator	Teflon	Gold

OUTLINE DRAWING

Unit:mm

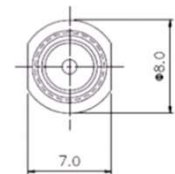
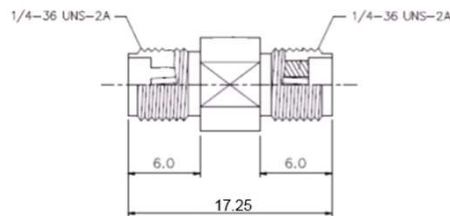

TESTING DATA (100% S-PARAMETER TESTED)

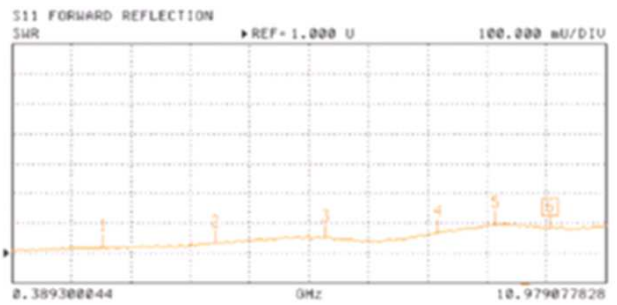
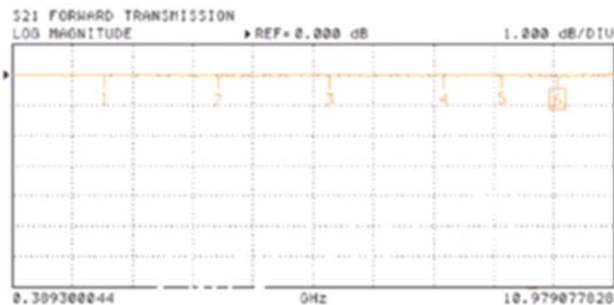

Any more request, please contact sales@solvangtech.com. Thank you ~