



18GHZ SMA FEMALE TO SMA FEMALE

BULKHEAD ADAPTER

P/NO.STI01-0148



SPECIFICATION

Frequency	DC~18GHz
VSWR:	1.3:1(Max.)
Impedance:	500hm
Durability:	500 Cycles
Temperature:	-40~85 °C

MATERIAL LIST

Part	Material	Plated
Body	Brass	Gold
Center Pin	Phosphor Bronze	Gold
Insulator	Teflon	
Washer	Brass	Gold
Nut	Brass	Gold

OUTLINE DRAWING

Unit:mm

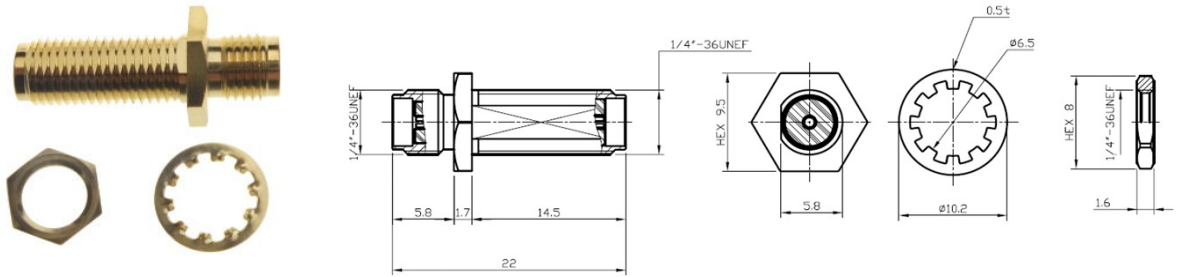

TESTING DATA (100% S-PARAMETER TESTED)

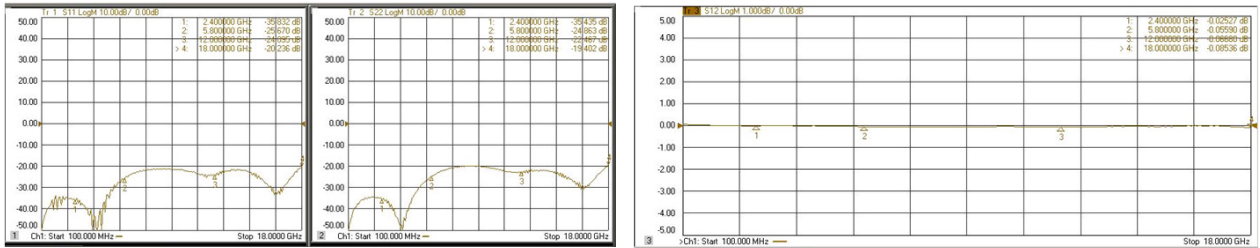

Any more request, please contact sales@solvangtech.com. Thank you ~